

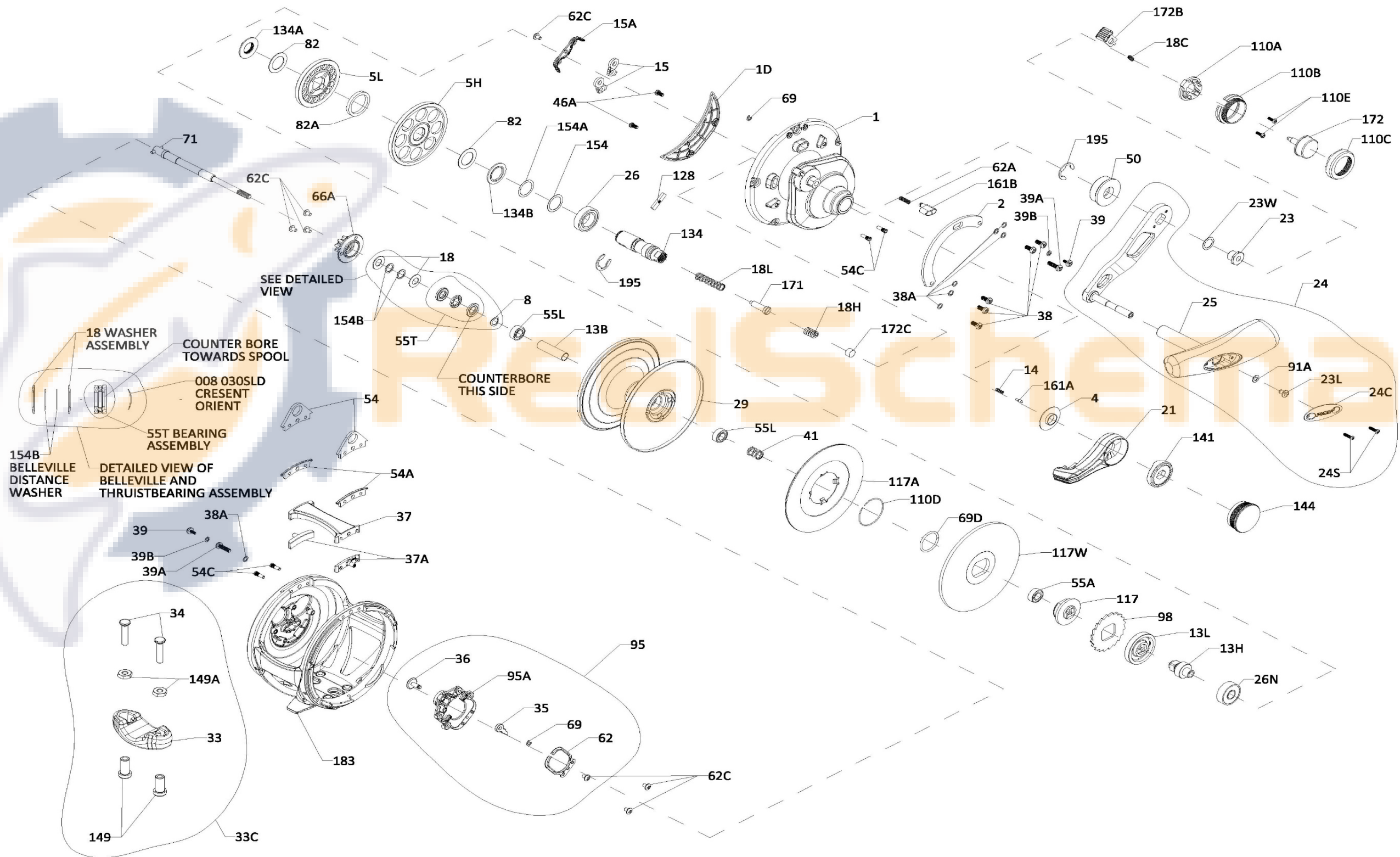

PARTS LIST FOR MODEL  
FATHOM II 60NLD2, 80LD2  
REEL PART NO. 1563184, 1563185





PARTS LIST FOR MODEL  
 FATHOM II 60NLD2, 80LD2  
 REEL PART NO. 1563184, 1563185

| Key No. | Part No. | Penn Style No.  | Description Parts List     | Key No. | Part No. | Penn Style No.  | Description Parts List    | Key No. | Part No. | Penn Style No.  | Description Parts List             |
|---------|----------|-----------------|----------------------------|---------|----------|-----------------|---------------------------|---------|----------|-----------------|------------------------------------|
| 1       | 1580166  | 1-FTHII60NLD2   | Right Side Plate (60N)     | 29      | 1580215  | 29-FTHII60NLD2  | Spool (60N)               | 82      | 1265070  | 82-TRQ40NLD2    | Washer Teflon (2 req)              |
| 1       | 1580168  | 1-FTHII80LD2    | Right Side Plate (80)      | 29      | 1580216  | 29-FTHII80LD2   | Spool (80)                | 82A     | 1265071  | 82A-30SLD2      | Washer Gear Separating             |
| 1D      | 1580172  | 1D-FTHII80LD2   | Gearbox Cover              | 33      | 1290729  | 33-TRQ          | Rod Clamp                 | 91A     | 1277514  | 91A-TRQ40NLD2   | Handle Knob Washer                 |
| 2       | 1580176  | 2-FTHII80LD2    | Quadrant                   | 33C     | 1580218  | 33C-FTHIILD2    | Rod Clamp Kit             | 95      | 1580237  | 95-FTHIILD2     | Click Module Assembly              |
| 4       | 1264978  | 4-TRQ15LD2      | Lever Washer               | 34      | 1580220  | 34-FTHIILD2     | Screw, Rod Clamp (2 req)  | 95A     | 1580238  | 95A-FTHIILD2    | Click Module Housing               |
| 5H      | 1264983  | 5-FTH40NLD2HS   | Main Gear High Speed (60N) | 35      | 1188656  | 35-20           | Click Tongue              | 98      | 1265073  | 98-FTH40NLD2    | Ratchet                            |
| 5H      | 1580180  | 5-FTHII80LD2HS  | Main Gear High Speed (80)  | 36      | 1516151  | 36-FTHII15SD    | Click Button              | 110A    | 1580239  | 110A-FTHIILD2   | Shift Button Base                  |
| 5L      | 1580183  | 5-FTHII80LD2LS  | Main Gear Low Speed        | 37      | 1580221  | 37-FTHII60NLD2  | Top Crossbar (60N)        | 110B    | 1580240  | 110B-FTHIILD2   | Shift Button Body                  |
| 8       | 1257843  | 8-30SLD         | Spring Washer              | 37      | 1580222  | 37-FTHII80LD2   | Top Crossbar (80)         | 110C    | 1580241  | 110C-FTHIILD2   | Shift Button Retain Ring           |
| 13B     | 1264997  | 13B-TRQ15LD2    | Spacer Tube (60N)          | 37A     | 1580223  | 37A-FTHII60NLD2 | Harness Lug Nut (2 req)   | 110D    | 1309895  | 110D-FTH15LD2   | Retaining Ring                     |
| 13B     | 1580187  | 13B-FTHII80LD2  | Spacer Tube (80)           | 38      | 1309885  | 38-FTH15LD      | Screw (5 req)             | 110E    | 1580242  | 110E-FTHIILD2   | Screw (2 req)                      |
| 13H     | 1264995  | 13-FTH40NLD2HS  | Pinion High Speed (60N)    | 38A     | 1188649  | 38A-20          | Flat Washer (7 req)       | 117     | 1580243  | 117-FTHII80LD2  | Drive Plate                        |
| 13H     | 1580190  | 13-FTHII80LD2HS | Pinion High Speed (80)     | 39      | 1580224  | 39-FTHII80LD2   | Screw (2 req)             | 117A    | 1580244  | 117A-FTHII80LD2 | Drag Washer (Assembly)             |
| 13L     | 1580193  | 13-FTHII80LD2LS | Pinion Low Speed           | 39A     | 1580225  | 38-FTHII60NLD2  | Screw (2 req)             | 117W    | 1580245  | 117W-FTHII80LD2 | Drag Washer Metal                  |
| 14      | 1181406  | 14-535          | Spring                     | 39B     | 1589724  | 39B-FTHII80LD2  | Flat Washer (2 req)       | 128     | 1265084  | 128-30SLD2      | Shift Key                          |
| 15      | 1229374  | 15-TRQ40        | Dog Asm (2 req)            | 41      | 1265056  | 41-TRQ40NLD2    | Drag Disengaging Spring   | 134     | 1265085  | 134-30SLD2      | Gear Stud                          |
| 15A     | 1580194  | 15A-FTHIILD     | Anti Rev Dog Retainer      | 46A     | 1488755  | 46A-FTHII30LW   | Cover Plate Screw (2 req) | 134A    | 1265086  | 134A-30SLD2     | Nut Gear Stud                      |
| 18      | 1265001  | 18-TRQ40NLD2    | Spring Washer (2 req)      | 50      | 1309889  | 50-FTH60LD2     | Shield Guard              | 134B    | 1265087  | 134B-30SLD2     | Washer Support Gear Stud           |
| 18C     | 1181632  | 18C-15KG        | Spring Shift Button        | 54      | 1580226  | 54-FTHII60NLD2  | Harness Lug (2 req)       | 141     | 1580246  | 141-FTHIILD     | Cam Follower                       |
| 18H     | 1265002  | 18H-30SLD2      | Spring                     | 54A     | 1580227  | 54A-FTHII60NLD2 | Harness Lug Plug (2 req)  | 144     | 1580247  | 144-FTHIILD     | Preset Knob Assembly               |
| 18L     | 1265003  | 18L-30SLD2      | Spring                     | 54C     | 1580228  | 54C-FTHII60NLD2 | Harness Lug Screw (4 req) | 149     | 1184702  | 149-45          | Rod Clamp Nut (2 req)              |
| 21      | 1580202  | 21-FTHII80LD2   | Drag Lever                 | 55A     | 1238912  | 55A-50SLD       | Ball Bearing              | 149A    | 1184706  | 149-200         | Hex Nut (2 req)                    |
| 23      | 1580203  | 23-FTHIILD2     | Screw Handle Nut           | 55L     | 1286985  | 55L-20          | Ball Bearing (2 req)      | 154     | 1265092  | 154-TRQ40NLD2   | Gear Stud Shim (As Required)       |
| 23L     | 1191283  | 23L-750         | Screw                      | 55T     | 1238913  | 55T-30SLD       | Thrust Bearing            | 154A    | 1306668  | 154A-TRQ40NLD2  | Gear Stud Shim (As Required)       |
| 23W     | 1286986  | 23W-TRQ40NLD2   | Handle Nut Washer          | 62      | 1188664  | 62-20           | Click Spring              | 154B    | 1309903  | 154B-FTH25NLD2  | Belleville Distance Washer (2 req) |
| 24      | 1580206  | 24-FTHII80LD2   | Handle Assembly            | 62A     | 1236596  | 62-TRQ40        | Spring Click Locator      | 161A    | 1265098  | 161A-TRQ15LD2   | Lever Click Pin                    |
| 24C     | 1361267  | 24C-16VIS       | Cap- Handle Knob           | 62C     | 1188654  | 62C-20          | Screw (7 req)             | 161B    | 1265099  | 161B-TRQ40NLD2  | Strike Button                      |
| 24S     | 1580207  | 24S-FTHII80LD2  | Screw (2 req)              | 66A     | 1265059  | 66A-FTHLD       | Click Gear                | 171     | 1265101  | 171-30SLD2      | Plunger Gear Shift                 |
| 25      | 1580208  | 25-FTHII80LD2   | Handle Knob                | 69      | 1188657  | 69-20           | Retainer (2 req)          | 172     | 1580248  | 172-FTHIILD2    | Shift Button Assembly              |
| 26      | 1265023  | 26-TRQ40NLD2    | Bearing                    | 69D     | 1265060  | 69D-FTH15LD     | Retaining Ring            | 172B    | 1580249  | 172B-FTHIILD2   | Shift Latch                        |
| 26N     | 1182145  | 26N-25          | Bearing                    | 71      | 1580235  | 71-FTHII60NLD2  | Spindle (60N)             | 172C    | 1184831  | 172B-30VS       | Spacer                             |
|         |          |                 |                            | 71      | 1580236  | 71-FTHII80LD2   | Spindle (80)              | 183     | 1580262  | 183-FTHII60NLD2 | Frame Assembly (60N)               |
|         |          |                 |                            |         |          |                 |                           | 183     | 1580264  | 183-FTHII80LD2  | Frame Assembly (80)                |
|         |          |                 |                            |         |          |                 |                           | 195     | 1184955  | 195-40          | Retaining Ring (2 req)             |



Thank you for your recent PENN gear purchase. No matter where you fish or what you fish for, you can depend PENN to perform in any battle day in and day out. Now it's time to get your product registered and get out on the water.

<https://register.pennfishing.com>